

## PHASE 1 LOT PRICES

[whisperingcoves.com](http://whisperingcoves.com)

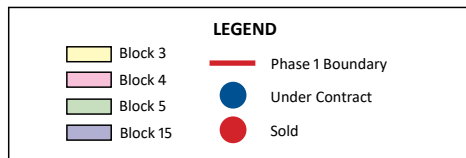
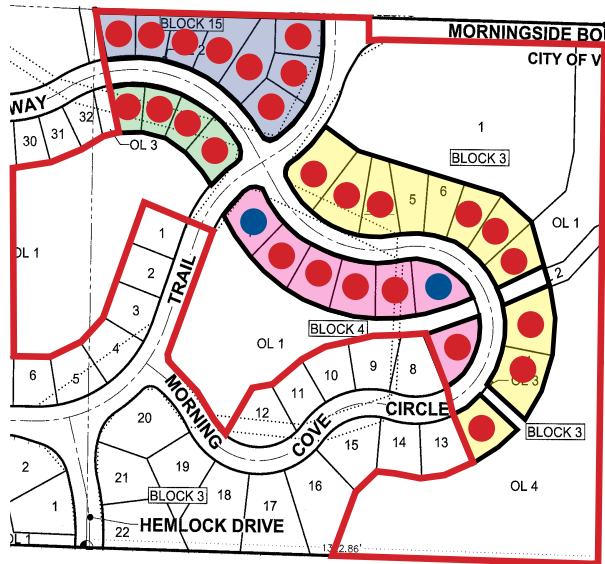

| Block | Lot | Square Feet | Price                 | Exposure | Features                    |
|-------|-----|-------------|-----------------------|----------|-----------------------------|
| 3     | 2   | 20,040      | <b>Sold</b>           | Standard | Central Location/Open Space |
| 3     | 3   | 17,007      | <b>Sold</b>           | Lookout  | Central Location/Open Space |
| 3     | 4   | 14,661      | <b>Sold</b>           | Lookout  | Central Location/Open Space |
| 3     | 5   | 13,270      | \$198,900             | Lookout  | Central Location/Open Space |
| 3     | 6   | 11,289      | \$198,900             | Walkout  | Central Location/Open Space |
| 3     | 7   | 11,923      | <b>Sold</b>           | Walkout  | Central Location/Open Space |
| 3     | 8   | 13,048      | <b>Sold</b>           | Walkout  | Central Location/Open Space |
| 3     | 9   | 12,940      | <b>Sold</b>           | Walkout  | Trail/Pond/Open Space       |
| 3     | 10  | 17,243      | <b>Sold</b>           | Walkout  | Trail/Pond/Open Space       |
| 3     | 11  | 17,896      | <b>Sold</b>           | Walkout  | Trail/Pond/Open Space       |
| 3     | 12  | 14,892      | <b>Sold</b>           | Walkout  | Trail/Pond/Open Space       |
| 4     | 1   | 15,355      | <b>Under Contract</b> | Standard | Trail/Open Space            |
| 4     | 2   | 13,042      | <b>Sold</b>           | Lookout  | Pond/Open Space             |
| 4     | 3   | 13,586      | <b>Sold</b>           | Lookout  | Pond/Open Space             |
| 4     | 4   | 14,109      | <b>Sold</b>           | Lookout  | Pond/Open Space             |
| 4     | 5   | 13,662      | <b>Sold</b>           | Lookout  | Trail/Open Space            |
| 4     | 6   | 14,257      | <b>Under Contract</b> | Standard | Trail/Open Space            |
| 4     | 7   | 14,984      | <b>Sold</b>           | Lookout  | Trail/Open Space            |
| 5     | 33  | 9,154       | <b>Sold</b>           | Lookout  | Trail/Pond                  |
| 5     | 34  | 9,516       | <b>Sold</b>           | Lookout  | Trail/Pond                  |
| 5     | 35  | 9,516       | <b>Sold</b>           | Standard | Trail/Pond                  |
| 5     | 36  | 12,685      | <b>Sold</b>           | Standard | Trail/Pond                  |
| 15    | 12  | 10,679      | <b>Sold</b>           | Standard | Pond/Open Space             |
| 15    | 13  | 9,830       | <b>Sold</b>           | Standard | Pond/Open Space             |
| 15    | 14  | 11,716      | <b>Sold</b>           | Standard | Pond/Open Space             |
| 15    | 15  | 16,356      | <b>Sold</b>           | Standard | Pond/Open Space             |
| 15    | 16  | 16,663      | <b>Sold</b>           | Standard | Pond/Open Space             |
| 15    | 17  | 13,810      | <b>Sold</b>           | Standard | Central Location            |
| 15    | 18  | 11,360      | <b>Sold</b>           | Standard | Central Location            |
| 15    | 19  | 11,616      | <b>Sold</b>           | Standard | Central Location            |